

- ✓ Suitable for M5 and M8 inductive sensors
- ✓ Two plungers available
- ✓ Maximum force up to 2000 N

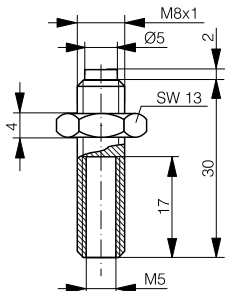

AMS-0001-M08

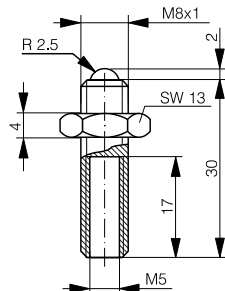

AMS-0002-M08

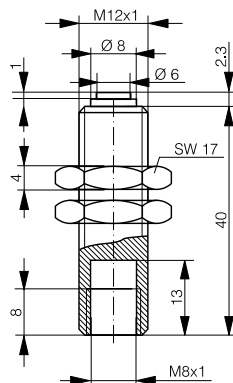

AMS-0001-M12

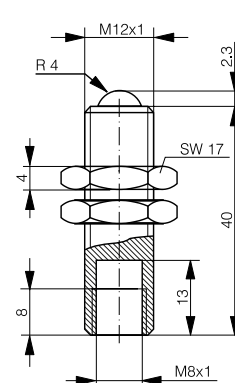

AMS-0002-M12

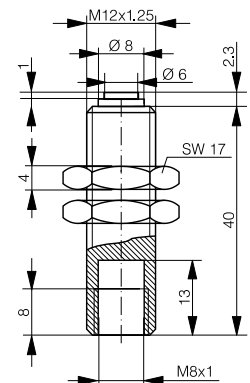

AMS-1001-M12

### SUITABLE SENSORS

DW-AS-60x-M5	DW-AS-62x-M5	DW-AS-60x-M8-001 DW-AS-60x-M8-129	DW-AS-62x-M8-001 DW-AS-62x-M8-129	DW-AS-60x-M8-001 DW-AS-60x-M8-129
--------------	--------------	--------------------------------------	--------------------------------------	--------------------------------------

### MECHANICAL DATA

Material	Steel XC 48, black
Max. tightening torque	30 Nm (M8), 50 Nm (M12)
Max. force on housing	8'000 N (M8), 15'000 N (M12)
Max. force on plunger	2'000 N

### AVAILABLE TYPES

Part number	Part reference	Inner diameter	Outer diameter	Weight	Plunger type
605-000-708	AMS-0001-M08	M5x0.5	M8x1	12.7 g	Flat <sup>1)</sup>
605-000-706	AMS-0002-M08	M5x0.5	M8x1	12.7 g	Spherical <sup>2)</sup>
605-000-707	AMS-0001-M12	M8x1	M12x1	33 g	Flat <sup>1)</sup>
605-000-705	AMS-0002-M12	M8x1	M12x1	33 g	Spherical <sup>2)</sup>
xxx-xxx-xxx	AMS-1001-M12	M8x1	M12x1.25	33 g	Flat <sup>1)</sup>

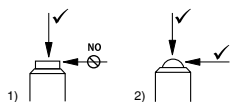

Operators of the products we supply are responsible for compliance with measures for the protection of persons. The use of our equipment in applications where the safety of persons might be at risk is only authorized if the operator observes and implements separate, appropriate and necessary measures for the protection of persons and machines. Terms of delivery and rights to change design reserved.

- ✓ Convient pour capteurs inductifs M5 et M8
- ✓ Deux pistons disponibles
- ✓ Force maximale jusqu'à 2000 N

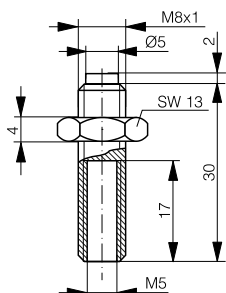

AMS-0001-M08

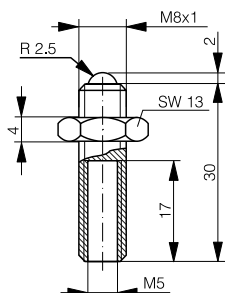

AMS-0002-M08

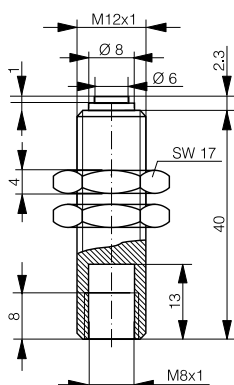

AMS-0001-M12

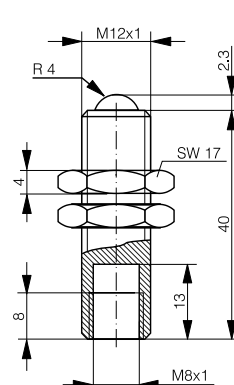

AMS-0002-M12

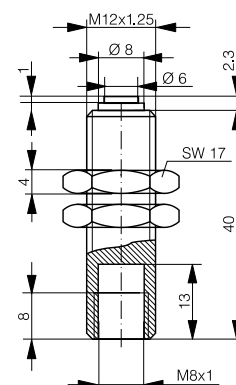

AMS-1001-M12

### CAPTEURS CORRESPONDANTS

DW-AS-60x-M5	DW-AS-62x-M5	DW-AS-60x-M8-001 DW-AS-60x-M8-129	DW-AS-62x-M8-001 DW-AS-62x-M8-129	DW-AS-60x-M8-001 DW-AS-60x-M8-129
--------------	--------------	--------------------------------------	--------------------------------------	--------------------------------------

### DONNÉES MÉCANIQUES

Matériau	Acier XC 48, noir
Couple de serrage max.	30 Nm (M8), 50 Nm (M12)
Force max. sur boîtier	8'000 N (M8), 15'000 N (M12)
Force max. sur piston	2'000 N

### TYPES DISPONIBLES

Numéro d'article	Désignation	Diamètre intérieur	Diamètre extérieur	Poids	Type de piston
605-000-708	AMS-0001-M08	M5x0.5	M8x1	12,7 g	Plat <sup>1)</sup>
605-000-706	AMS-0002-M08	M5x0.5	M8x1	12,7 g	Sphérique <sup>2)</sup>
605-000-707	AMS-0001-M12	M8x1	M12x1	33 g	Plat <sup>1)</sup>
605-000-705	AMS-0002-M12	M8x1	M12x1	33 g	Sphérique <sup>2)</sup>
xxx-xxx-xxx	AMS-1001-M12	M8x1	M12x1.25	33 g	Plat <sup>1)</sup>

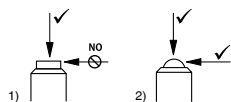

Les exploitants des produits que nous fournissons sont tenus d'assurer des mesures adéquates de protection des personnes. L'utilisation de nos appareils dans des applications comportant un risque possible pour la sécurité des personnes n'est admissible que si l'exploitant observe et met en œuvre des mesures séparées, appropriées et nécessaires pour la protection des personnes et des machines. Sous réserve de modifications et de possibilités de livraison.

- ✓ Geeignet für M5- und M8-Induktivsensoren
- ✓ Zwei Stößel erhältlich
- ✓ Maximalkraft bis zu 2000 N

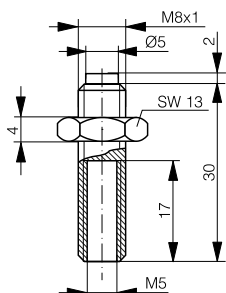

AMS-0001-M08

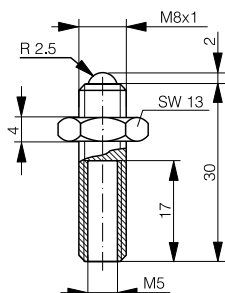

AMS-0002-M08

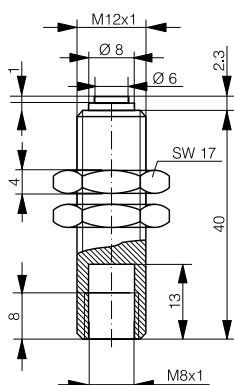

AMS-0001-M12

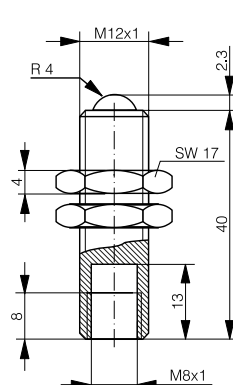

AMS-0002-M12

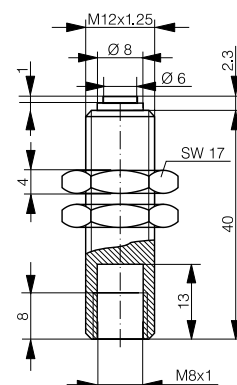

AMS-1001-M12

### PASSENDE SENSOREN

DW-AS-60x-M5	DW-AS-62x-M5	DW-AS-60x-M8-001 DW-AS-60x-M8-129	DW-AS-62x-M8-001 DW-AS-62x-M8-129	DW-AS-60x-M8-001 DW-AS-60x-M8-129
--------------	--------------	--------------------------------------	--------------------------------------	--------------------------------------

### MECHANISCHE DATEN

Material	Stahl XC 48, schwarz
Maximales Anzugsdrehmoment	30 Nm (M8), 50 Nm (M12)
Maximalkraft auf Gehäuse	8'000 N (M8), 15'000 N (M12)
Maximalkraft auf Stößel	2'000 N

### TYPENSPEKTRUM

Artikelnummer	Bezeichnung	Innendurchmesser	Aussendurchmesser	Gewicht	Stößel-Typ
605-000-708	AMS-0001-M08	M5x0.5	M8x1	12,7 g	flach <sup>1)</sup>
605-000-706	AMS-0002-M08	M5x0.5	M8x1	12,7 g	sphärisch <sup>2)</sup>
605-000-707	AMS-0001-M12	M8x1	M12x1	33 g	flach <sup>1)</sup>
605-000-705	AMS-0002-M12	M8x1	M12x1	33 g	sphärisch <sup>2)</sup>
xxx-xxx-xxx	AMS-1001-M12	M8x1	M12x1.25	33 g	flach <sup>1)</sup>

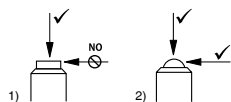

Die Einhaltung der Personenschutzmaßnahmen obliegt dem Betreiber der von uns gelieferten Produkte. Der Einsatz unserer Geräte in Anwendungen, bei welchen die Sicherheit von Personen gefährdet sein könnte, ist nur dann zulässig, wenn der Betreiber gesonderte geeignete und notwendige Maßnahmen für die Personen- und Maschinensicherheit einhält und vornimmt. Änderungen und Liefermöglichkeiten vorbehalten.